

# EWAY

## E-WAY FULL ELECTRIC – 18m

**IVECO**  
**BUS**  
Drive the road of change

OPRcharge

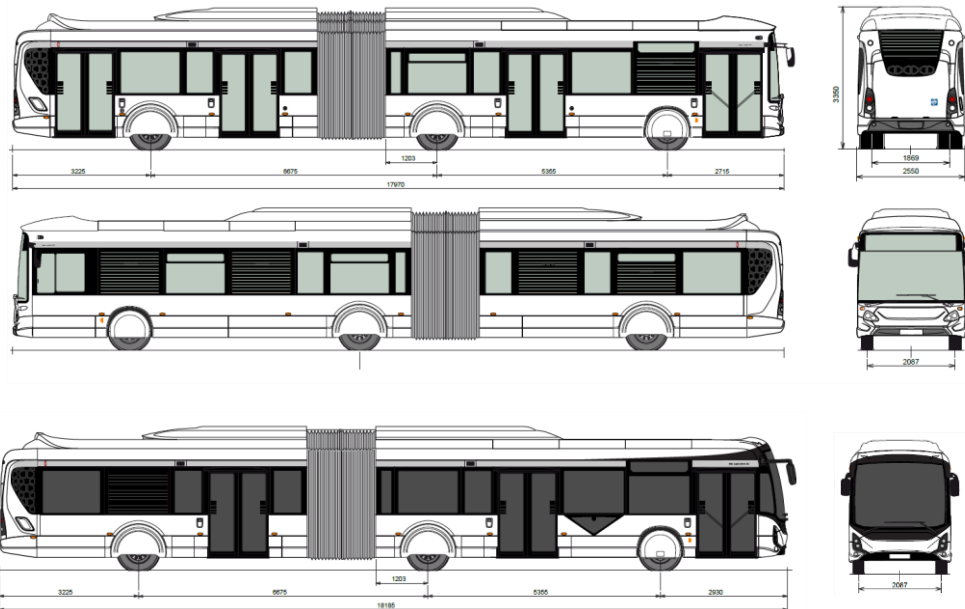

Layout 18m

42 seats + “wheelchair” space (x) + driver

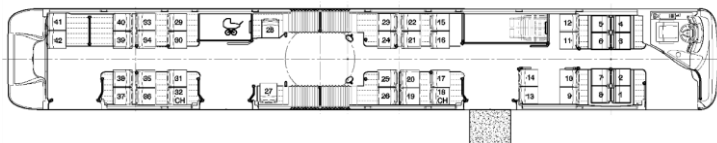

### WEIGHTS

Gross kerb weight	according to equipment
G.V.W. max permitted weight	30 000 kg

### DIMENSIONS

Overall length	17,970 m
Overhang	2,715/3,225 m
Wheelbase	5,355/6,675 m
Overall width	2,550 m
Total height, full load	3,350 m
Inside headroom (front part/rear part)	2,384/2,262 m
Slope of the floor (rear part only)	7,2 %
1st step height	
Front door	0,320 m
Center & rear door	0,330/0,340 m
Width of front / center / rear doors	1,200 m
Floor height	0,340 m
Ground clearance, under skirt	0,300 m
Front/rear tracking	2,087/1,869 m
Inner Turning radius	10,182 m
Outer Turning radius	11,650 m
Angle of attack / escape	7,4°/7,4°
BRT version in option (Overall)	18,185 m

## E-WAY FULL ELECTRIC – 18m

### ELECTRICAL ARCHITECTURE

Batteries using LTO cells (Lithium Titanate Oxide)

	High power battery	Flex battery
	3 or 4 door version	3 door version for Europe
Serial	102 kWh	
Option	117 kWh	250 kWh
Electric motor	240 kW	Asynchronous 160/200 kW (torque 2100/2405 Nm)

Off board pantograph serial, option on board pantograph

Charging system:

- CCS Combo2 for balancing load (100 kW)
- 4 poles pantograph up to 450 kW

### CHASSIS AND STRUCTURE - EXTERIOR TRIM

Self supporting integral structure. Anti corrosion treatment of chassis by cathodic immersion. Body structure consisting in 5 panels (front/rear/left/right/top) made of welded stainless steel sections and sheet panels. Assembling of the 8 panels to the chassis by bolting. 12mm thick plywood floor, protected by phenolic resins on both sides and wax containing resins on ground side. Composite front and rear ends, roof and side panels. Bonded assembly. Gravel resistant protected wheel arches. Composite front and rear bumpers in 3 parts.

BRT options:

GX LINIUM front end wheel covers.

### ACCESS AND DOORS

3 or 4 inward swing/sliding doors. Both leaves of front door are double glazed. Electrical access ramp on the central door. Left and right self de frosting rear view mirrors or motor driven and self de frosting rear view mirrors with integrated flag holders.

### GLAZING – HEATING – COOLING

TSA tinted or Shade

Lite panoramic laminated glass windscreen bonded on front face. Bonded side windows. Driver's window: sliding type in front part. TSA tinted glass all round or Grey 40 or Venus 35 tinted except driver's window, front door and rear window.

With or without triangular window on platform

HVO

or fuel or electric 20 kW or mix HVO/electric or fuel/electric heater

4 air exhausters on rear part of the roof

With or without passenger and/or driver's compartment air conditioning

With or without additional heater in passenger compartment

With or without motor driven or hand actuated opaque or translucent roof hatches.

### DRIVER'S COMPARTMENT

Adjustable steering wheel (height and angle). Air suspended driver's seat with adjustment control on right hand side. VDV instrument panel with warning lamps and control display panel.

Pivoting door, wall behind the driver with a glazed upper part. Interior rear View mirrors. Left side and front sun visor. Driver's individual with 2 spotlights, luggage box. Average fuel consumption on dashboard.

Adjustable steering wheel and dashboard in height and in slope

With or without anti aggression gate

### INTERIOR TRIM

« wheelchair and pram » space

Epoxy or stainless steel stanchions and handrails.

High wear resistant floor covering up to plinths top. Laminated roof and side panels.

Thermo formed wheel arches. Polyester ceiling arches.

With or without fire extinguisher

### ELECTRICAL EQUIPMENT

2-off 12 V 225 A/h maintenance-free batteries mounted on a sliding support located in an outside compartment at the vehicle front left-hand side.

Converter DC/DC 600/24 V

Passenger compartment lighted by ledsights.

Door sleplighting at door opening. Lighting of driver's compartment, paying position and steps. Electricity-saving system for intensive use whilst engine is off.

Thermal circuit-breakers.

Battery re-loading and engine start FENWICK socket

Front and rear lights with lads: parking lights, stop lights, fog lights, reverse lights and turning lights. Corner marker lights with leds.

FMS socket

8 passenger's loudspeakers and 1 driver loudspeaker and 1 outside loudspeaker

Preparation for front or lateral electronic destination indicator.

With or without flashing/stop indicators on the top of rear end.

With or without atmosphere lightings.

With or without complete radio equipment.

With or without monoringgong for pedestrian zone.

With or without Front fog lights

With or without 24 V plug in engine compartment

Preparation for ITxPT

With or without Intellibustelematics system

### FRONT AXLE

Front independent wheels.

### REAR AXLE

ZF AV 133

Axle torque: 5,76 (21x38)

### SUSPENSION

Constant height air suspension.

Kneeling and raising system (72 mm stroke) on vehicle right-hand side, controlled from the driving position.

### COMPRESSED AIR

Pressure: 10 bars. Electric compressor (output: 400 l/min). Single tower air dryer.

Manual bleeding on the air tanks. Cyclone air cleaner. Oil separator.

### BRAKES

Service brakes: air-controlled disc brakes at the front and at the rear. . ABS-ASR braking system. EBS braking system.

Parking brake and door brake controlled via separate circuits.

Pneumatic parking brake actuated by lack of air, spring chamber on rear wheels.

Service braking: electrical FAE

Brakes applied by opening of the central door.

### WHEELS AND TYRES

Michelin or Bridgestone

275/70 R 22.5 tires at the front, twin tires at the rear.

With or without wheel covers.

### CERTIFICATION

In accordance with the R100-2 Regulation

In accordance with the appendix 8 of the ECE R107 Regulation and with the appendix 11 of the decree of August 3rd, 2007