

# CROSSWAY

CROSSWAY LOW ENTRY LINE 10.8/12/13/14,5 m – DIESEL EURO VI STEP E MH

**IVECO**  
**BUS**  
Drive the road of change



|   |                      |           |           |                           |
|---|----------------------|-----------|-----------|---------------------------|
| <b>Length</b>   | 10,845 mm            | 12,050 mm | 12,965 mm | 14.495 mm                 |
| <b>Width</b>  | 2,550 mm             |           |           |                           |
| <b>Height (with / without a/c)</b>                              | 3330 mm              |           |           |                           |
| <b>Wheelbase</b>  | 4,825 mm             | 6,030 mm  | 6,945 mm  | 6,945 mm / 1,530 mm       |
| <b>Front / rear overhang</b>                                    | 2,725 / 3,295 mm     |           |           |                           |
| <b>Front / middle door access height</b>                        | 320 mm / 330 mm      |           |           |                           |
| <b>Front / middle width</b>                                     | 800 mm / 1,200 mm    |           |           |                           |
| <b>Wall-to-wall turning radius</b>                              | 9,140 mm             | 10,720 mm | 11,930 mm | 11,930 mm                 |
| <b>Kerb-to-kerb turning radius</b>                              | 7,300 mm             | 8,870 mm  | 10,070 mm | 10,070 mm                 |
| <b>Approach / departure angles</b>                              | 7° / 7°              |           |           |                           |
| <b>GVW (max permitted weight depends on local legislation)</b>  | 17,900 kg            |           |           | 24,000 kg                 |
| <b>Max. WEIGHT FRONT / 2<sup>nd</sup> / 3<sup>rd</sup> AXLE</b> | 11,600 kg / 6,300 kg |           |           | 6,300 / 11,600 kg / 6,300 |

Layout 10,8 m

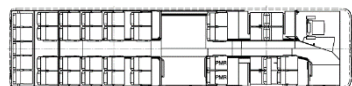

37 passengers seats

Layout 12 m

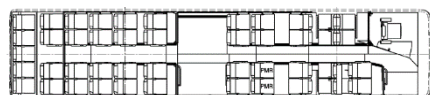

45 passengers seats

Layout 13 m



49 passengers seats

Layout 14,5 m

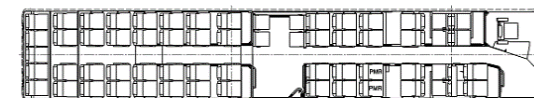

57+4 passengers seats

|                     | <b>CURSOR 9</b>                                 | <b>MH system</b>            |
|---------------------|---|-----------------------------|
| <b>Power</b>        | 265 kW (360 hp) @ 2,200 rpm                     | 25kW continuous / 35kW peak |
| <b>Torque</b>       | 1,600 Nm @ 1,200 rpm                            | 300Nm                       |
| <b>Displacement</b> | 8.7 litres                                      |                             |
|                     | 6 cylinders in line, vertical rear, Common Rail |                             |

# CROSSWAY

## CROSSWAY LOW ENTRY LINE 10.8/12/13/14,5 m – DIESEL EURO VI STEP E MH

### BODY AND EXTERIOR EQUIPMENT

- Anticorrosion cathaphoretic treatment of the structure and of the body, finished with a polyurethane resin final coat
- Front door 800 mm 1 leaf, middle door 1200 mm 2 leaves, external opening
- Access to the front lights through opening corners

### INTERIOR EQUIPEMENT

- Self-adhesive anti-slip PVC carpet on the floor
- Lateral walls covered by laminated panels
- Roof covered by laminated panels
- Separation walls made of laminated panels
- Central platform in front of the middle door
- Internal luggage racks for passengers
- Passengers' seats LINEO
- Manual ramp for disabled persons

### ELECTRICAL EQUIPMENT

- Two batteries 12 V – 225 AH
- Two alternators 150 A
- Electrical box with fuses in the front left compartment
- LED Lights: front and rear direction lights, rear position lights, rear brake lights, lateral lights and side markers
- LED DRL
- Front Halogen lights, fog lights
- Fire extinguishing system
- 24 V, 12 V and 2x USB sockets on the dashboard

### WINDOWS/ THERMAL COMFORT

- Tinted simple glass with 5 opening units (4 units for 10.8 m)
- Two roof hatches, manual control
- Four heaters for the passengers compartment
- Independent heater

### DRIVER'S COMPARTMENT

- Adjustable driver's seat with air suspension, headrest, 3 pts safety belt
- Lateral and front sun visors with manual control
- Driver's separation
- On board computer with fuel consumption control
- Digital tachograph

### OPTIONAL

- External rearview mirrors, heated, with electrical control
- Ski carrier preparation
- Towing device preparation

### OPTIONAL

- Electrical ramp for disabled persons
- Curtains on lateral windows
- Refrigerator integrated in the dashboard
- Cantilever seats

### OPTIONAL

- Xenon front lights
- Corner light (integrated in the fog light)
- Warning lights with open doors
- Reverse sensors, reverse camera

### OPTIONAL

- Two roof hatches with electrical control
- Double glasses of the lateral and rear windows, driver's window and passengers doors
- A/C with or without heating
- Electrical defrosting of the front steps
- Electrical defrosting of the windshield

### OPTIONAL

- Driver's seat with heating system
- Driver's box with lock
- Driver's refrigerator
- Additional driver's heater
- Driver's A/C
- Front sun visor with electrical control
- Alco lock tester

### AFTER TREATMENT SYSTEM EVI

- HI-SCR after treatment system, main components: Diesel Oxydation Catalyst, Diesel Particulate Filter, Selective Catalytic Reduction of Nox with AdBlue®, Clean Up Catalyst

### GEARBOX

- Automatic gearbox VOITH Diwa NXT (7 gears)

### MILD HYBRID EQUIPMENT

- 48V electric motor: 25kW continuous, 35kW peak / 300 Nm
- 48V Lithium battery: 1 kWh
- Battery and cooling group modules located on the roof

### REAR AXLE

- Single reduction hypoid rear axle equipped with "Quiet ride gears set" for low noise
- Standard axle ratio: 4.63

### FRONT AXLE/ STEERING

- Front axle with independent wheels suspension
- Worm-type steering with integrated power steering

### SUSPENSION

- Full air suspension with self-leveling sensor
- Front: 2 combined air springs/2 shock absorbers/1 leveling sensor
- Rear: 4 air springs / 4 shock absorbers /1 stabilization bar / 2 leveling sensors

### COMPRESSED AIR

- Dual cylinder air compressor 630 cm<sup>3</sup> (pressure 9.5 bar)
- Integrated air dryer: bleeding valves on the air tanks

### BRAKES

- EBS/ESP
- Pneumatic service and emergency braking system with two independent air circuits
- Brake discs, front and rear, with floating calipers and ABS
- Pneumatic parking brake, operating on the rear wheels

### RETARDER

- Decompression engine brake
- Hydraulic integrated retarder

### FUEL TANK AND UREA TANK

- 200 litres diesel tank
- 80 litres AdBlue® tank

### TYRES AND WHEELS

- 275/70 R 22.5 tyres

### OPTIONAL

- Lifting/Lowering of the vehicle's suspensions
- Reinforced shock absorbers
- Kneeling

### OPTIONAL

- AEBS

### OPTIONAL

- 320 litres diesel tank