

STREETWAY

12 m - 18.75 m CITY BUS LOW FLOOR – CURSOR 9 CNG EURO VI STEP E

IVECO
BUS
Drive the road of change



| | 12 m | 18.75 m |
|--|--------------------|--------------------------|
| Length | 12,000 mm | 18,750 mm |
| Width | 2,540 mm | |
| Height | 3,390 mm | |
| Wheelbase | 5,900 mm | 5,900 / 6,740 mm |
| Front / rear overhang | 2,700 / 3,400 mm | 2,700 / 3,400 mm |
| Front / rear track | 2,160 / 1,890 mm | 2,160 / 1,890 mm |
| Front / rear internal height | 2,438 / 2,431 mm | 2,438 / 2,431 mm |
| Front / middle / rear door access height | 330 / 330 / 330 mm | 330 / 330 / 330 / 330 mm |
| Front / middle / rear door width | 1,200 mm | |
| External turning circle | 11,600 mm | 12,000 mm |
| Internal turning circle | 3,500 mm | 4,700 mm |
| Kerb-to-kerb turning radius | 9,200 mm | 10,100 mm |
| Approach / departure angles | 7° / 7° | 7° / 7° |
| Max. Technically permissible GVW* | 20,000* kg | 29,000* kg |
| Max. Technically permissible axle loads* | Front axle | 7,750* kg |
| | Middle axle | - |
| | Rear axle | 12,500* kg |

* Max allowed vehicle axles load and GVW is depending on local regulation in registration country

| | CURSOR 9 CNG EURO VI | |
|--------------|---|------------------------------|
| | 12 m | 18.75 m |
| Power | 228 kW (310 hp) at 1,900 rpm | 264 kW (360 hp) at 1,900 rpm |
| Torque | 1,300 Nm at 1,100 rpm | 1,640 Nm at 1,100 rpm |
| Displacement | 8.7 liters | |
| | 6 cylinders in line, longitudinal at the rear | |

Layout 12 m

3 doors

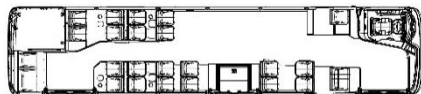

24 seats + 1 wheelchair & pram area
24 to 32 Seats

2 doors



26 seats + 1 wheelchair & pram area
26 to 34 Seats

Layout 18,75m

4 doors

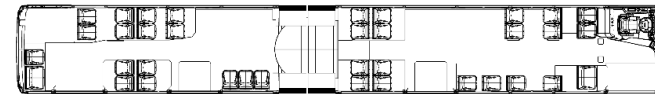

36 seats + 1 wheelchair & pram area
31 to 47 Seats

3 doors



38 seats + 1 wheelchair & pram area
33 to 49 Seats

STREETWAY

12 m - 18.75 m CITY BUS LOW FLOOR – CURSOR 9 CNG EURO VI STEP E

BODY AND EXTERIOR EQUIPMENT

- Vehicle Type M3 Class 1 (EU type approval)
- ECE R 107.07 compliant
- Steel construction with anti-corrosion by cathaphoresis treatment
- Self – supporting structure made of 6 panels welded together
- Roof made of sandwich composite panel (fiberglass + polystyrene + fiberglass)
- Side panel aluminum segments glued to body
- Front and rear bumpers made of polyester
- Doors with inward opening, with manual ramp at second door
- Access to rear engine compartment by engine door, by rear upper flap, by left side maintenance flaps and through interior engine flap

INTERIOR EQUIPMENT

- Passenger seats Kiel IDEO, seat trimming plastic
- 1 wheelchair place (UFR), combine with place for pram (12 m),
- 1 wheelchair place (UFR) + 1 place for pram (18 m)
- Roof center finishing panels covered formica by vinylux (leatherette)
- Roof side covers made of molded ABS
- Painted handrails or stainless steel as option
- 6 kg fire extinguisher inside driver cabin
- 8 stop buttons and sign box on front (12 m), in case 18 m 13 stop buttons

ELECTRICAL EQUIPMENT

- Multiplex electric system
- Charged batteries 2x 225 Ah, mounted on a sliding tray
- Alternators: 2 x 150 A for 12 m and 3 x 150 A for 18.75 m
- Electric circuit battery switch on dashboard and manual in battery compartment
- NATO plug for battery charging
- Protection electric circuits by resettable fuses
- Audio preparation: driver speaker, wiring with speakers in passengers' area 6 pcs (12 m), 8 pcs (18 m), amplifier Yilka
- Interior LED roof lighting (switch for different light intensity) and driver area
- LED for DRL, side markers and door accesses
- Upper LED rear lights (stop and direction lamps)

WINDOWS/ THERMAL COMFORT

- Tinted side windows
- Tilting upper part ventilation windows in standard or sliding as option
- Manual sliding driver's window
- Roof hatches glazed, manually operated in standard or electrically as option
- Thermal insulation of sides panel
- Thermal and sound insulation of engine compartment
- Heating front box
- De-icing of windscreen by front box blowers
- Ventilation of driver area by front box through dashboard nozzles

DRIVER'S COMPARTMENT

- External rear view mirrors with electric de-icing, manual control
- Closed driver cabin, driver door with half glazing
- Adjustable driver dashboard on steering wheel column and left side console
- Upper driver's storage
- 2 adjustable air ducts on dashboard and 2 foots nozzles for driver thermal comfort
- Driver seat with air suspension with safety belt

OPTIONAL

- 12 m: 2 or 3 door versions
- 18 m: 3 or 4 door versions
- Electrical wheelchair access ramp

OPTIONAL

- Personalized seat's trimming (fabric with foam)
- 2 wheelchairs layout (12 m)
- 2 wheelchairs + 1 pram layout (18 m)

OPTIONAL

- Front fog lamps
- Microphone for driver
- Amplifier Bosch instead of standard

OPTIONAL

- Floor heating by 2 heaters (12 m), by 3 heaters (18 m)
- Independent heater 30 kW
- A/C unit roof-mounted for passengers, 39 kW (12 m); 48 kW /2x24 kW/ (18 m)
- A/C with reheating function
- Double glazed side windows
- Double glazed door glazing

OPTIONAL

- Electric control rear view mirrors
- Different driver cabin door option
- Optional driver seats Grammer, ISRI

ENGINE

- Upper exhaust pipe with outlet on the roof toward back
- After treatment system
- Fire detection of engine compartment with alert on dashboard
- Engine fire extinguisher system with water mist

GEARBOX

- Standard versions: automatic gearbox VOITH Diwa 6 with SENSOTOP or ZF Ecolife 2 with TOPODYN
- 3 or 6 touch gearbox selector

REAR AXLE

- Lowered rear axle ZF AV 133
- Lowered middle axle ZF AVN 132 (18 m)
- Anti-roll bar
- Max vehicle speed is limited up to 90 km/h

FRONT AXLE/ STEERING

- Front axle IFS RL 82 EC with independent suspension
- Worm-type steering Hema with integrated power steering

SUSPENSION

- Electronic full air suspension with self-levelling function, vehicle kneeling function

COMPRESSED AIR

- Dual cylinder air compressor 630 cm³
- APU unit in air circuit with function air processing (air drying and oil separation)
- Low carbon steel air tanks

BRAKES

- Pneumatically-controlled service brake, front and rear disks brakes
- E.B.S. (A.B.S. with A.S.R.)
- Dual independent circuits front and rear
- Parking brake

RETARDER

- Hydraulic retarder incorporated into the gearbox and linked to the service brake pedal

GAS TANK

- 12 m: 4 longitudinal bottles (1280 liters) – CNG3
- 18 m: 5 longitudinal bottles (1600 liters) - CNG3
- NGV2 Left and Rear right hand side filling

TYRES AND WHEELS

- Type: 275/70 R22.5 148/145 J
- Steel Rims 22.5x7.5

OPTIONAL

- Exhaust pipe outlet at ground level toward back

| Length | Axle Ratio |
|---------|--------------------|
| 12 m | 5,76 (S) / 6,2 (O) |
| 18,75 m | 6,20(S) / 5,76 (O) |

OPTIONAL

- ESP (12m only)

OPTIONAL

- Manual lever to control retarder

- 12 m: 5 longitudinal bottles (1600 liters) – CNG3
- 18 m: 5 longitudinal bottles + 1 transversal bottles (1805 liters) - CNG3

OPTIONAL

- Other tires brands